

Swap body bolster rigid 160 x 85

- > steel raw
- > 1 twist lock on each side (*galvanised inner parts 410.075.620*)
- > **with 2 galvanised guide rollers**
- > with welded holder for guide rollers
- > bolster 85 mm high
- > weight 78 kg

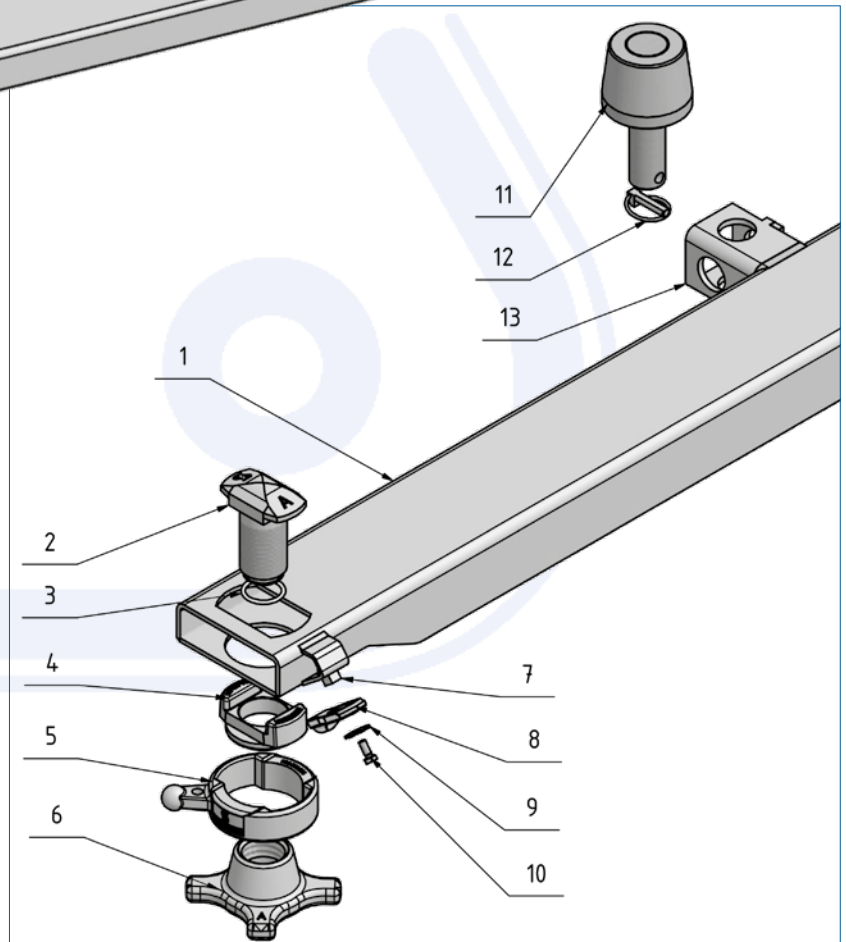

Art.-No. 410.077.500

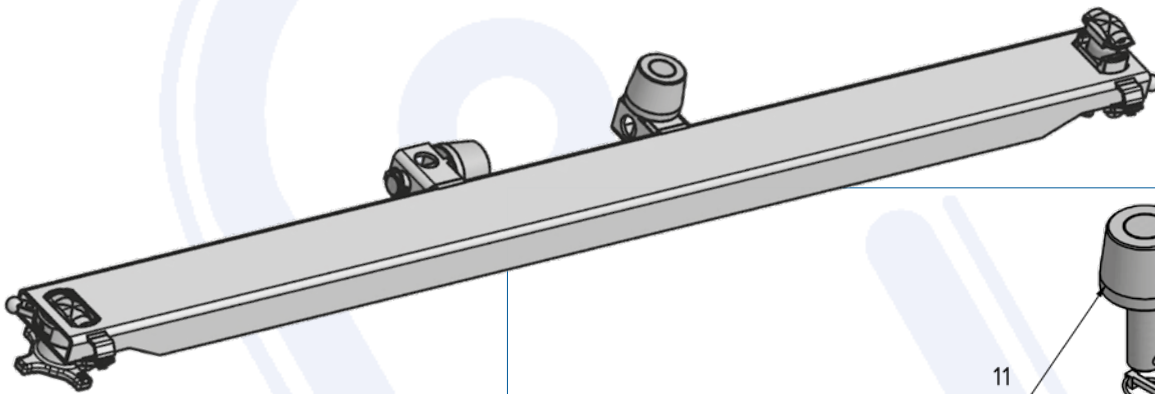
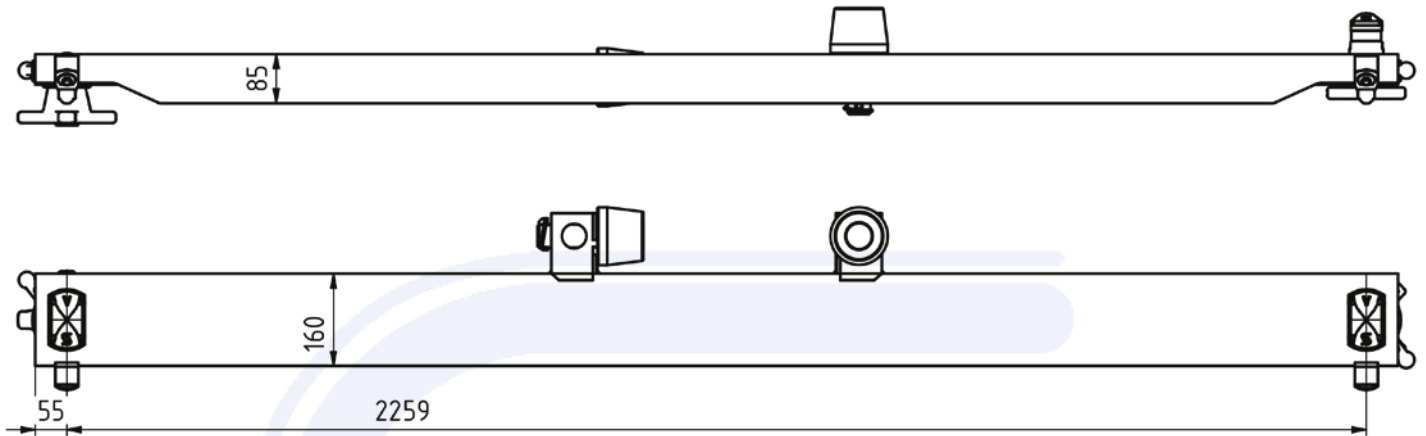

| Pos. | Single part | Art.-No. |
|------|---------------------------|-------------|
| 1 | Bolster | 410.077.502 |
| 2 | Locking pin | 906.000.276 |
| 3 | Security ring | 905.000.187 |
| 4 | Locking pin guide | 906.000.273 |
| 5 | Outer guide | 906.000.274 |
| 6 | Locking nut | 906.000.275 |
| 7 | Holder for security latch | 905.159.006 |
| 8 | Security latch | 905.159.005 |
| 9 | Washer | 905.036.005 |
| 10 | Screw | 020.008.016 |
| 11 | Guide roller | 640.003.110 |
| 12 | Folding pin | 640.003.112 |
| 13 | Holder for guide roller | 640.003.005 |