

# Twist lock fully retractable

- > for swap systems right hand side
- > with 52 mm locking pin and security ring
- > steel housing raw for welding on, all inner parts are galvanized and not installed
- > 170 x 175 x 125 mm
- > weight 10 kg

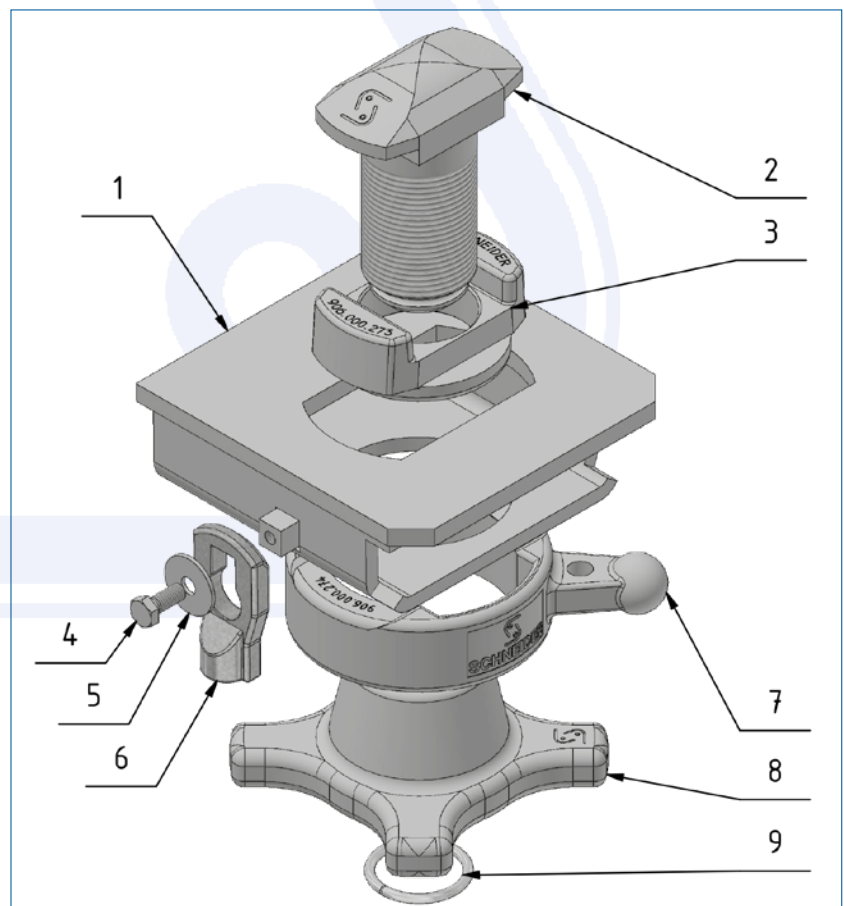

Art.-No. 905.273.150

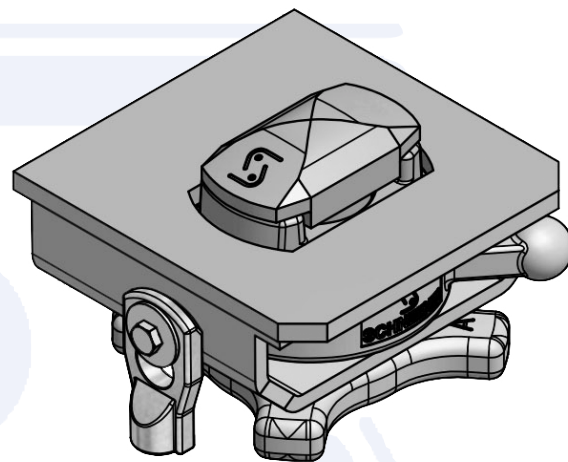
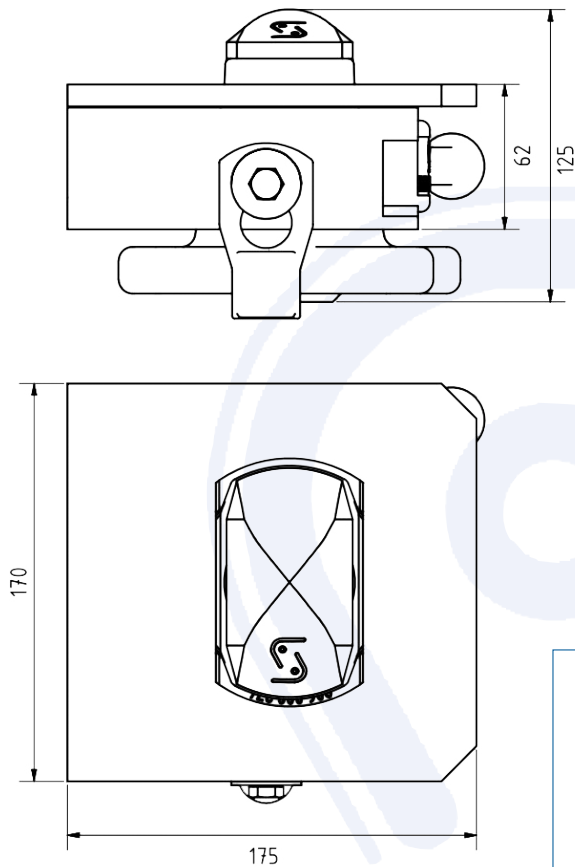

Pos.	Single part	Art.-No.
1	Housing right	906.273.150
2	Locking pin	906.000.276
3	Locking pin guide	906.000.273
4	Screw M8x16	020.008.016
5	Safety washer	905.036.005
6	Security latch	905.159.005
7	Outer guide	906.000.274
8	Locking nut	906.000.275
9	Security ring	905.000.187