

Twist lock fully retractable

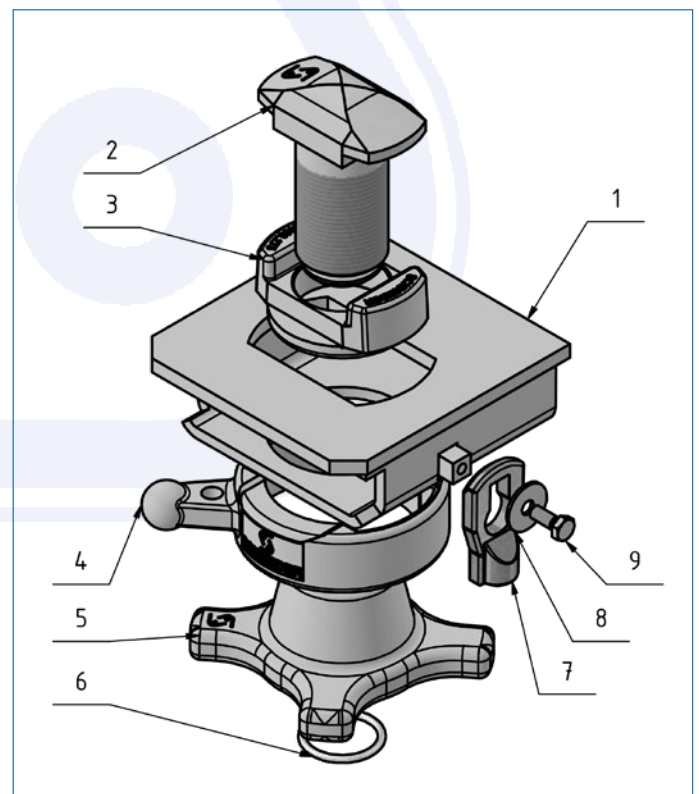

- > for swap systems left hand side
- > with 52 mm locking pin and security ring
- > steel housing raw for welding on, all inner parts are galvanized and not installed
- > 170 x 175 x 125 mm
- > weight 10 kg

Art.-No. 905.273.250

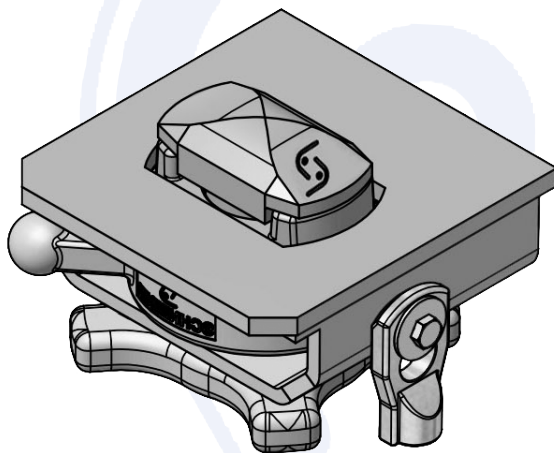
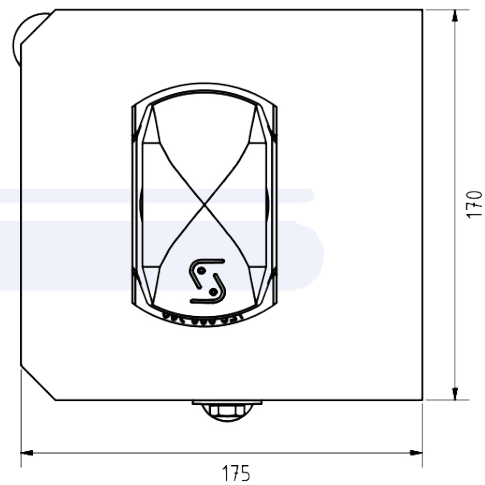
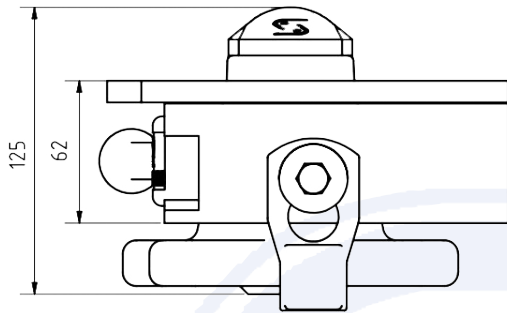

Pos.	Single part	Art.-No.
1	Housing left	906.273.250
2	Locking pin	906.000.276
3	Locking pin guide	906.000.273
4	Outer guide	906.000.274
5	Locking nut	906.000.275
6	Security ring	905.000.187
7	Security latch	905.159.005
8	Safety washer	905.036.005
9	Screw M8x16	020.008.016